

iVSEC X MOBILE APP

Remote access via Mobile Devices

Prerequisites: The NVR must be connected to an active Internet connection.

The NVR can be accessed remotely via the iVSEC X mobile application

1) Download iVSEC X from Google Play Store Apple Store

2) Open the app, click on  or , then click on  Device List

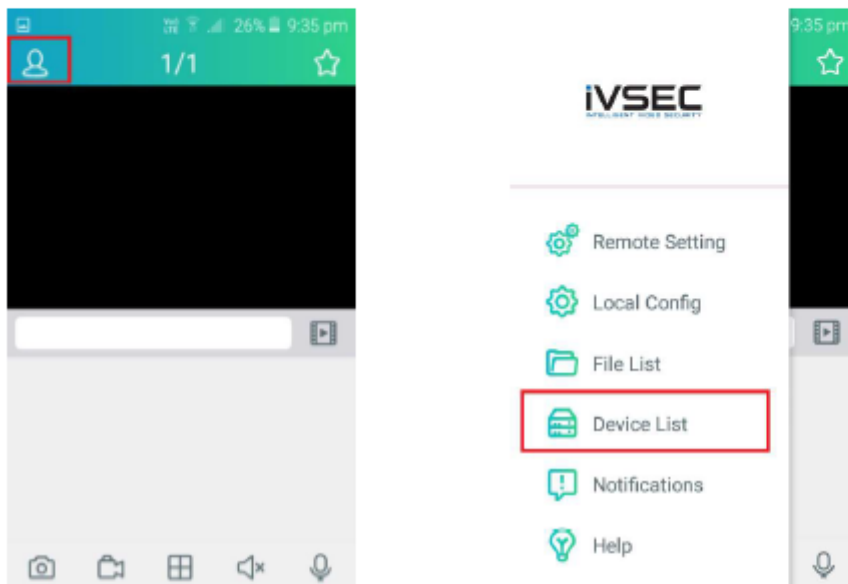

3) Touch the  icon, then touch **IPC/NVR/DVR**

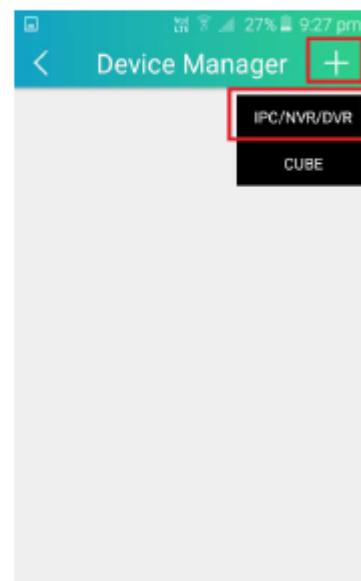

- 4) Scan the QR code on top of the NVR. Then, enter the NVR password and press "Save"

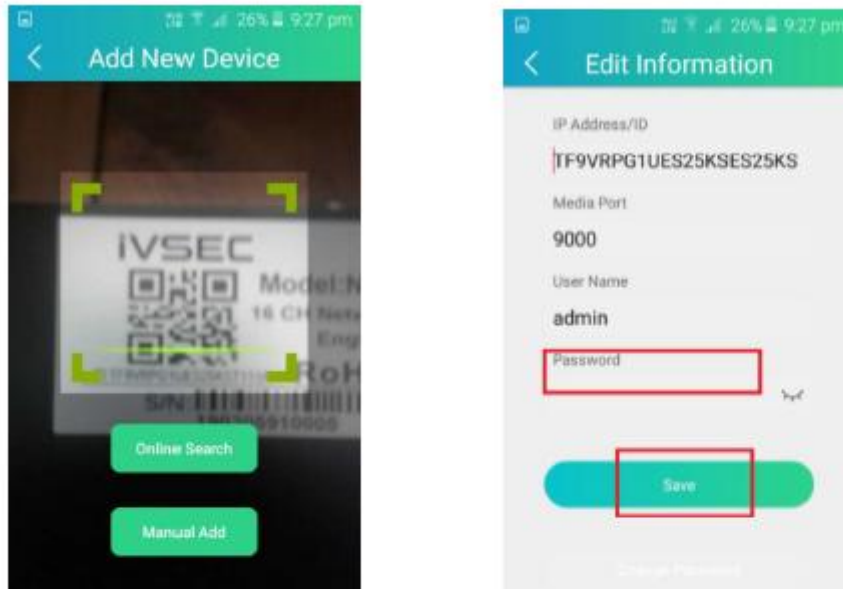

- 5) Connection Status should be **Connected**. Click on the  to view the cameras

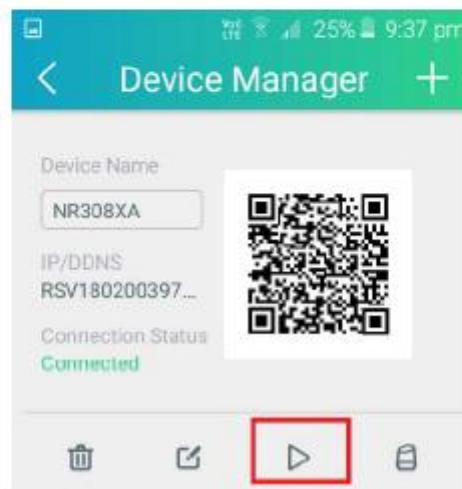

If the Connection Status shows: **Connect Close** ensure that DHCP is enabled in the Network settings of the NVR and that your Internet connection is working.

FAQ

1. Q: How to setup the IVSEC X app on my Smartphone
 A: Please refer to YouTube link: <https://youtu.be/71mvg5QdsfY>
 Scan the appropriate QR code below to download the IVSEC X app



2. How to reduce camera buffering when accessing IVSEC cameras on the mobile app
 A: Please refer to YouTube link: <https://youtu.be/fPismrsE3a8>
3. Q: Where can I download the IVSEC X-Range NVR User manual
 A: [Click here to download IVSEC X User Manual](#)
4. Q: Where can I download the IVSEC X NVR / Camera Quick User Guide
 A: [Click here to download IVSEC X NVR Quick User Guide](#)
[Click here to download IVSEC X Camera Quick User Guide](#)
5. Q: How to setup motion detection on an IVSEC X-Range NVR
 A: Please refer to YouTube link: <https://www.youtube.com/watch?v=HpR8Jvz2iD8>
6. Q: How to configure Event Triggered Recording
 A: [Click here to download ETR Instructions](#)
7. Q: How to export footage from an IVSEC X-Range NVR
 A: Please refer to YouTube link: <https://www.youtube.com/watch?v=NYxL970aR6E>
8. Q: How to factory default an IVSEC X-Range NVR
 A: Please refer to YouTube link: <https://www.youtube.com/watch?v=JjdXepvpFIU>
9. Q: How to login to an IVSEC NVR or camera using Internet Explorer or Chrome
 A: Please refer to YouTube link: <https://youtu.be/H-3uULik0Lk>
[Click here to download Chrome IE Tab Extension \(Windows\)](#)

10. Q: How can I search for IVSEC devices on a network or change an IP address
A: Please refer to YouTube link: <https://youtu.be/2mVoYhTRmRo>
[Click here to download device config tool for Windows](#)

11. Q: How to install the VMS application for Windows
A: Please refer to YouTube link: <https://youtu.be/jv5cYr93bUY>
[Click here to download VMS \(Windows\)](#)

12. Q: How to remotely access your NVR / cameras using the Windows VMS application
A: Please refer to YouTube link: <https://youtu.be/GlbMN6PiAJc>
[Click here to download VMS \(Windows\)](#)

13. Q: How to add 2N IP Verso Intercom camera to an IVSEC NVR:
A: Please refer to YouTube link: https://youtu.be/bS47s8fYx_o

14. Q: How to Setup 3rd Party cameras onto an IVSEC X-Range NVR
A: Please refer to YouTube link: <https://www.youtube.com/watch?v=bUwHHilbZWg>
[Click here to download Device manager tool](#)
[Click here to download IVSEC PTZ Search Tool](#)

15. Q: Where can I download the previous version of Surveillance Client for Windows
[Click here for Surveillance client \(Win 32-bit\)](#)
[Click here for Surveillance client \(Win 64-bit\)](#)

16. Q: How to setup the surveillance client on Windows
A: Please refer to YouTube link: <https://youtu.be/tbakdNGsKsw>

17. Q: Where can I download the Surveillance client, device config tool & video player for MAC
[Click here for Surveillance client \(MAC\)](#)
[Click here for Device Config Tool \(MAC\)](#)
[Click here to download video player \(MAC\)](#)

18. Q: How to setup the surveillance client on MAC
A: Please refer to YouTube link: https://youtu.be/_sJovaT-oD8

19. Q: How to playback and export footage from surveillance client on a MAC
A: Please refer to YouTube link: <https://youtu.be/qOwoQZA9CRY>

20. Q: How to reset my NVR password?
A: [Click here to download IVSEC Password Reset Procedure](#)

21. Q: Where can I find additional support
A: Scan the QR code below or go to www.ivsecurity.com.au/FAQ